

## Double Acting Cylinder

Type CPT-...

With adjustable cushioning at both ends

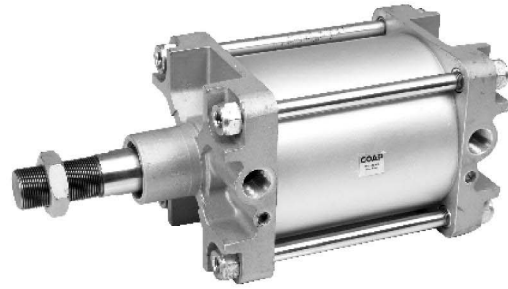

Type CPT-...M

With magnet for proximity sensing

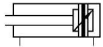

Order example:

CPT - 160 - 100 - M - T	
Options	T
Magnetic version	M
Stroke length	100
Diameter	160
Type	CPT

Options:

T	Through piston rod	
E	Extended piston rod	
A	Acid resistant piston rod	
H	Heat resistant seals max. 150 °C	
F	Female thread on piston rod	
M	Extended male thread on piston rod	

Technical Data:

Operating medium	Filtered compressed air
Operating pressure	1.5 ... 10 bar
Temperature range	-20 ... + 80°C
Piston Ø	160, 200, 250 & 320 mm
Stroke length	10 ... 2000 mm

Materials:

Cylinder barrel	Aluminium, anodised
Piston rod	C 1050-50 micron hard chrome coated
Caps, bearing & end	Aluminium
Piston	Aluminium
Seals	Polyurethane, nitrile rubber

Theoretical forces at 6 bar:

Piston Ø (mm)	Advancing force (N)	Retracting force (N)
160	12,060	11,110
200	18,840	17,890
250	29,450	28,280
320	48,250	46,380

Dimensions (mm):

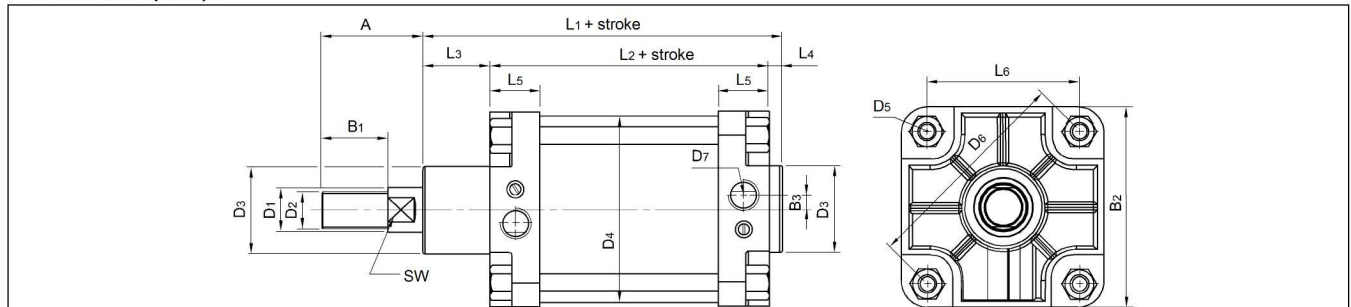

Note: For mounting attachments & rod components see section (3.5.0 Cylinder accessories).

Piston Ø (mm)	A	B <sub>1</sub>	B <sub>2</sub>	B <sub>3</sub>	D <sub>1</sub> Ø	D <sub>2</sub>	D <sub>3</sub> Ø	D <sub>4</sub> Ø	D <sub>5</sub>	D <sub>6</sub>	D <sub>7</sub>	L <sub>1</sub> + stroke	L <sub>2</sub> + stroke	L <sub>3</sub>	L <sub>4</sub>	L <sub>5</sub>	L <sub>6</sub>	SW
160	97	72	186	13.5	40	M36X2	65	170	M16	198	G3/4	243	180	55	8	47	140	41
200	102	72	220	13.5	40	M36X2	75	210	M16	247.5	G3/4	253	180	65	8	47	175	41
250	122	84	270	14	50	M42X2	90	262	M20	311.1	G1	281	200	69	12	51	220	46
320	134	96	340	20	63	M48X2	110	336	M24	381.8	G1	314	220	82	12	56	270	55